

**REQUEST FOR ALTERATION OR ADDITION**

**UNIT # \_\_\_\_\_**

**TO:** Architectural Review Committee – Canyon Club Condominiums HOA

**DATE:** \_\_\_\_\_

**FROM:** \_\_\_\_\_  
Owner Name(s)

\_\_\_\_\_  
Owner Address

**PLAN:** Detailed description of alteration or addition (Include Illustrations, photos, product details, etc...)

\_\_\_\_\_  
\_\_\_\_\_  
\_\_\_\_\_  
\_\_\_\_\_  
\_\_\_\_\_  
\_\_\_\_\_  
\_\_\_\_\_  
\_\_\_\_\_  
\_\_\_\_\_  
\_\_\_\_\_  
\_\_\_\_\_  
\_\_\_\_\_

*(Continue on back or attach additional sheets as needed)*

**Number of Attached Sheets:** \_\_\_\_\_

\_\_\_\_\_  
Owner Signature Date

\_\_\_\_\_  
2<sup>nd</sup> Owner Signature (if applicable) Date

\_\_\_\_\_  
Contractor Signature  
(Contractor must have proof of liability and Workmen’s Compensation Insurance)

\_\_\_\_\_  
Company Name

**Architectural Review Committee Use Only**

APPROVED – Date \_\_\_/\_\_\_/\_\_\_\_\_

\_\_\_\_\_  
Signature of Arch Committee Chair

DENIED – Explanation attached

\_\_\_\_\_  
Signature of Maintenance Superintendent(*if needed*)

# Architectural & Modification Acceptance of Ownership & Responsibility Claim

This document outlines the scope of a project and provides acknowledgment of ownership and responsibility for any and all additions, modifications, and/or alterations made by a unit owner (or tenant with owner consent) within Canyon Club Condominiums.

Please print clearly on all portions of this form. Attach additional sheets and photos if needed. Please complete all sections

Unit # \_\_\_\_\_ Unit Owner(s) \_\_\_\_\_

Date Submitted: \_\_\_/\_\_\_/\_\_\_\_\_

# of Attached Documents: \_\_\_\_\_

Brief Description of Alteration/Addition: \_\_\_\_\_

\_\_\_\_\_

\_\_\_\_\_

\_\_\_\_\_

Common Areas that will be affected by Alteration/Addition: (Location and ways building exterior will be affected)

\_\_\_\_\_

\_\_\_\_\_

As the unit owner of above mentioned unit located at Canyon Club Condominiums - 6495 Happy Canyon Road – Denver, CO 80237 I acknowledge that I approve all modifications, alterations, and/or additions disclosed within all submitted documents for above mentioned project. I understand filing of this document must be accompanied by the filing of an Architectural Request form for the same project, that approval of both forms must be acquired **before** beginning any work on outlined project, and that alterations to approved project plans during project must be separately approved and attached to original approval documentation. I also understand access for periodic inspections may be required throughout the duration and at completion of said project. If such inspections are required they will be outlined in approval notes by Architectural Committee Chairperson and/or Maintenance Superintendent. Unapproved changes, or missed inspections may require removal of some or all current progress of project at my own cost.

Once project is complete I acknowledge that I, as the unit owner, hold sole responsibility for any and all repairs, maintenance, removal, and general care of all elements of said project. Additionally, I acknowledge that I shall be solely responsible for any costs incurred from damage caused directly, or indirectly, as a result of the construction and/or existence of above mentioned project. Lastly, I acknowledge that I shall be responsible to ensure above mentioned ownership and responsibility shall be documented and transferred to any and all future owners of unit. Canyon Club Condominiums Home Owners Association and any of its officers, agents, and/or employees shall be free of any responsibility (financial or otherwise) of above mentioned addition/alteration.

\_\_\_\_\_  
Unit Owner Signature

\_\_\_\_\_  
Date

\_\_\_\_\_  
2<sup>nd</sup> Unit Owner Signature (if needed)

\_\_\_\_\_  
Date

*\*Additional unit owner signatures (if more than 2 owners) shall be provided on separate sheet clearly labeled as attachment to this document.*

**This document must be filed in conjunction with an Architectural Request form, as well as any prints, plans, photographs, drawings, or permit documentation. This form alone does not grant approval for project.**

**Arch Committee Approval:** Attached sheets # \_\_\_\_\_ Approval Date: \_\_\_\_\_  
Signed and Printed Name: \_\_\_\_\_

**Maintenance Approval:** Attached sheets # \_\_\_\_\_ Approval Date: \_\_\_\_\_  
Signed and Printed Name: \_\_\_\_\_

# Concrete Addition Guidelines - Patio Additions

## General Information -

*All concrete slab additions must be approved by the Arch Committee and Maintenance PRIOR to any work performed. Inspections also to be performed of forms and rebar before concrete is poured.*

- Slabs are to be no less than 4" thick through the field, 6" thick at shoulders.
- All rebar to be #4 (1/2") and wired together at intersections.
- Rebar to be "shimmed" so as to keep rebar in center of pour except as noted at shoulders.
- Concrete to be no less than 3000psf rating. Fiberglass additive optional but encouraged.
- Expansion/stress joints to be cut into finish. Cut at even intervals evenly spaced no more than 60" apart.
- Any locations the new slab addition is adjacent to old concrete or the foundation, it must be secured with rebar drilled and epoxied\* into the existing no more than every 24" o.c. and embedded no less than 4" deep into existing concrete or foundation.
- All edges(including those not exposed)are to have minimum 6"x6" shoulders. See detail.
- Shoulder are to have two stacked runs of rebar 4" apart at all perimeters of new concrete

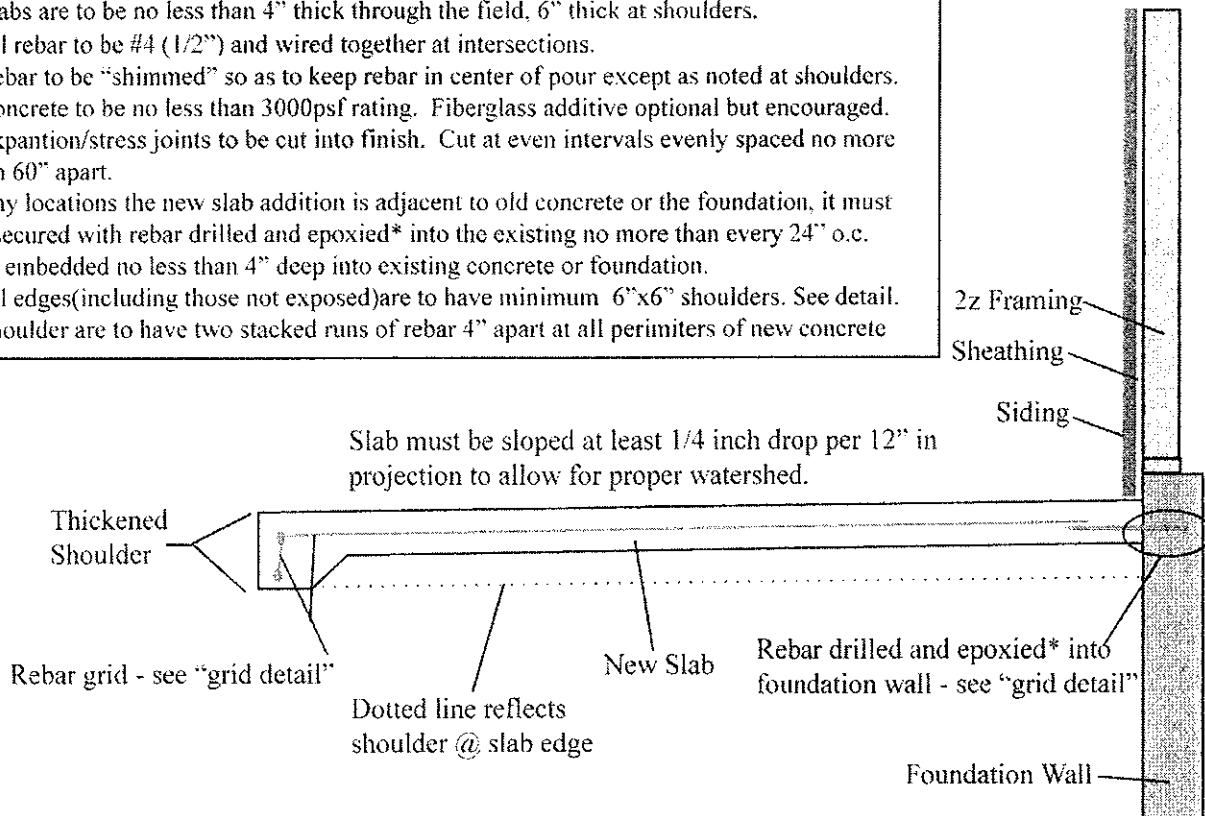

## Grid & Shoulder Details

At Foundation (see from above)

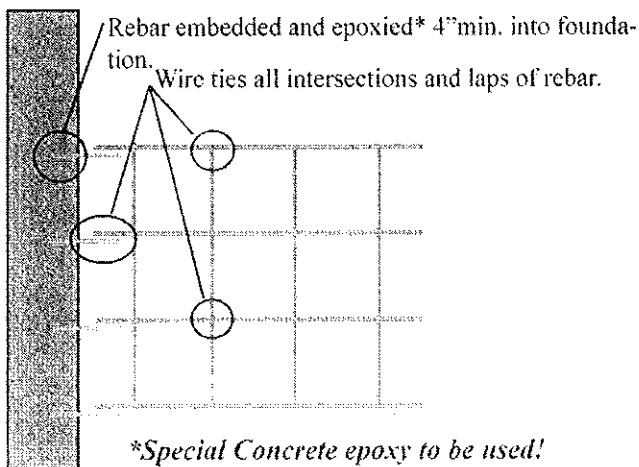

- Rebar should be wire-tied at all intersections and laps of rebar.
- At shoulders the grid bar is bent downward over the upper shoulder bar and ended at the lower bar.
- Shoulder depth and width does not include any slope to field slab in measurement.

Shoulder (as seen from side view)

